

- Landscape Areas**
- Wall Wash**
- Flagpole Lighting**
- Building Accent**
- Pedestrian Areas**
- Driveway Marker**
- Sign Lighting**



Specifications



Certifications ETL and CETL listed for wet location, direct burial, and concrete pour. Certified to IP65 and IP67 to ensure protection against the harshest environments. IEC compliant versions available, consult factory.

Lamp/Ballast Housing Compression molded Rhinolite™ composite material, structurally reinforced with glass fibers. Superior resistance to ultraviolet degradation and corrosion resistant in harsh environments. Trim Rng (TR) and Debris Cover (DC) supplied standard.

Splice Compartment Supplied with two 3/4" NPT conduit entrances. Connection to ballast compartment by way of anti-wicking device. Sealed with gasketed die cast aluminum cover plate. Suitable for through wiring.

Lens Standard 3/8" clear tempered flat borosilicate glass (F) or ADA anti slip and walkover clear tempered flat borosilicate glass (ADA). Flat lenses will withstand loads up to 200 PSI. Sealed to housing with high temperature injection molded silicone gasket. Optional linear spread lens also available.

Lens Frame Heavy duty die cast bronze lens frame is supplied as standard. Fastened to housing with six captive 10-24 stainless steel Allen cap screws.

Reflectors Spun aluminum highly specular Alzak™ finish for either NEMA type 1 or 2 spot (SPT) or NEMA type 3 or 4 flood (FLD) distributions. Field adjustable up to 25° tilt and 360° horizontal rotation. NOTE: Tilt adjustment varies by lamp type. A segmented fluorescent reflector is available for up to 42W lamps.

Lamp Holder Porcelain 4kv pulse rated medium base for HID and Incandescent lamp sources.

Options Cast aluminum Convex Rock Guard (CR), Directional Shield (DS), and Driveway Marker (DM). Internal Glare Shield (IGS), Internal Hex Cell Louver (HL), Glass Color Filter (GF), Grout Mask (GM), Die cast bronze Port Hole (PH).

Finish Housing Black (BK). Options can be painted in standard or custom colors. Powder Coat Standard.

Safety Caution: Care should be taken when specifying fixtures for use in pedestrian walkways to avoid problems that may be caused by high lens temperatures. Consult factory for more information.

Warning Caution: Care should be taken not to install in-ground fixtures in areas where water can stand for prolonged periods of time. Sufficient drainage must be provided to avoid problems. Consult factory for more information.

PROJECT
FIXTURE TYPE
CATALOG#



Some luminaires use fluorescent or high intensity discharge (HID) lamps that contain small amounts of mercury. Such lamps are labeled "Contains Mercury" and/or with the symbol "Hg." Lamps that contain mercury must be disposed of in accordance with local requirements. Information regarding lamp recycling and disposal can be found at www.lamprecycle.org

Product Order Guide

Series	Max Watts	Lamp Type	Voltage ⁶	Optics	Lens	Finish ⁶	Options
SL-23	Fluorescent						
	13CF	CF ¹	120	SPT ¹	Spot	F ¹ Clear Flat	BK ⁶ Black
	26CFQ	CFQ ¹	208			ADA ^{1,3} ADA Walkover	BZ ⁶ Bronze
	42CFT	CFT ¹	240	WW ¹	Wallwash	LS ¹ Linear Spread	WH ⁶ White
			277	FL ¹	Fluorescent		GR ⁶ Green
	High Pressure Sodium						
	70HPS	E17 ¹		NFLD ¹	Narrow Flood		NA ⁶ Natural Alum
				MFLD ¹	Medium Flood		GY ⁶ Gray
							CC ⁶ Custom Color
	Metal Halide						
	70MH	E17 ¹					IGS ¹ Glare Shield
	70MH	Par30 ^{1,8}					HL Hex Cell Louver
	39MH	Par20 ⁸					GF Glass Color Filter
							GM Grout Mask
							AHOT AIM-HOT™
							LFSS ¹ Stainless Steel Lens Frame
							STA ¹ Square Top Adaptor
	70MH	T6 or T4 ¹					
	70MH	R111 ^{1,8}					
	20MH	BT5 ¹	120				
	20MH	T4 ¹	120/277				
	Incandescent/Halogen/Low Voltage						
	75INC	Par30 ^{1,8}	120				
	100INC	T4mini ¹	120				
	50INC	Par20 ⁸	120				
	75INC	MR16 ⁸	120/277/12				
	50INC	AR111 ^{1,8}	120/277/12				
	LED						
	1X5 5WLED	CUS ^{1,9}	120-277	10,35,45	White (3050°K/ 4700°K)		
	Titan 25WW	CUS3 ^{1,9}	120-277	25,35,45	Warm White (3050°K)		
	Titan 25TC	CUS3 ^{1,9}	120-277	25,35,45	TruColor (3050°K) 1290 Raw Lumens.		
	Titan 25CW	CUS3 ^{1,9}	120-277	25,35,45	Cool (Daylight) White (4700°K)		
	Titan 25FIX	CUS3 ^{1,9}	120-277	25,35,45	Fixed Color Red, Green, Blue, Amber		

¹ Not available with the PH Porthole option, use Par20 or MR16 only.

CF=single biax, CFQ = double biax, CFT = triple biax

² The DM Driveway Marker can be used with any lamp option.

Note: E17 Lamps 150W and below are medium base

³ Use HPBB version if greater than 39W.

⁴ The PH Porthole option is supplied as standard in die cast bronze.

⁵ These options are supplied in heavy wall cast aluminum with baked enamel painted finish.

⁶ Consult factory for other voltages and finishes. Powder Coat Standard.

⁷ Consult factory for cast bronze options.

⁸ Does not require internal optics.

⁹ The CUS version uses a 5W Atlas from Lamina. The CUS3 uses a 25W Titan from Lamina with no tilt.

Example: SL-23-70MH-T6-277-SPT-F-BK-DS

Luminaire Dimensions

Luminaire	A		B		C		D		E		Weight	
	Inch	mm	Inch	mm	Inch	mm	Inch	mm	Inch	mm	lbs.	kg
SL-23-F	6.95	177	0.75	19	14.10	358	8.50	216	n/a	n/a	19	8.6
SL-23-PH	6.95	177	0.75	19	14.10	358	8.50	216	3.35	85	21	9.5
SL-23-DM	8.00	203	0.75	19	14.10	358	8.50	216	2.00	51	21	9.5
SL-23-CR	6.95	177	0.75	19	14.10	358	8.50	216	1.00	25	19.5	8.8
SL-23-DS	6.95	177	0.75	19	14.10	358	8.50	216	3.85	98	20	9.1

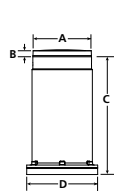

SL-23-F

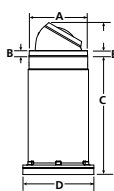

SL-23-PH

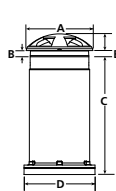

SL-23-DM

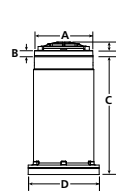

SL-23-CR

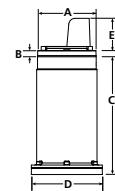

SL-23-DS