

WHD	G	08-039	JGB	8/22/08
WHD	H	09-065	ALD	8/4/09
WHD	I	10-137-006	ARG	3/14/11
APPR	REV	ISO DOC	BY	DATE

STREET SIDE

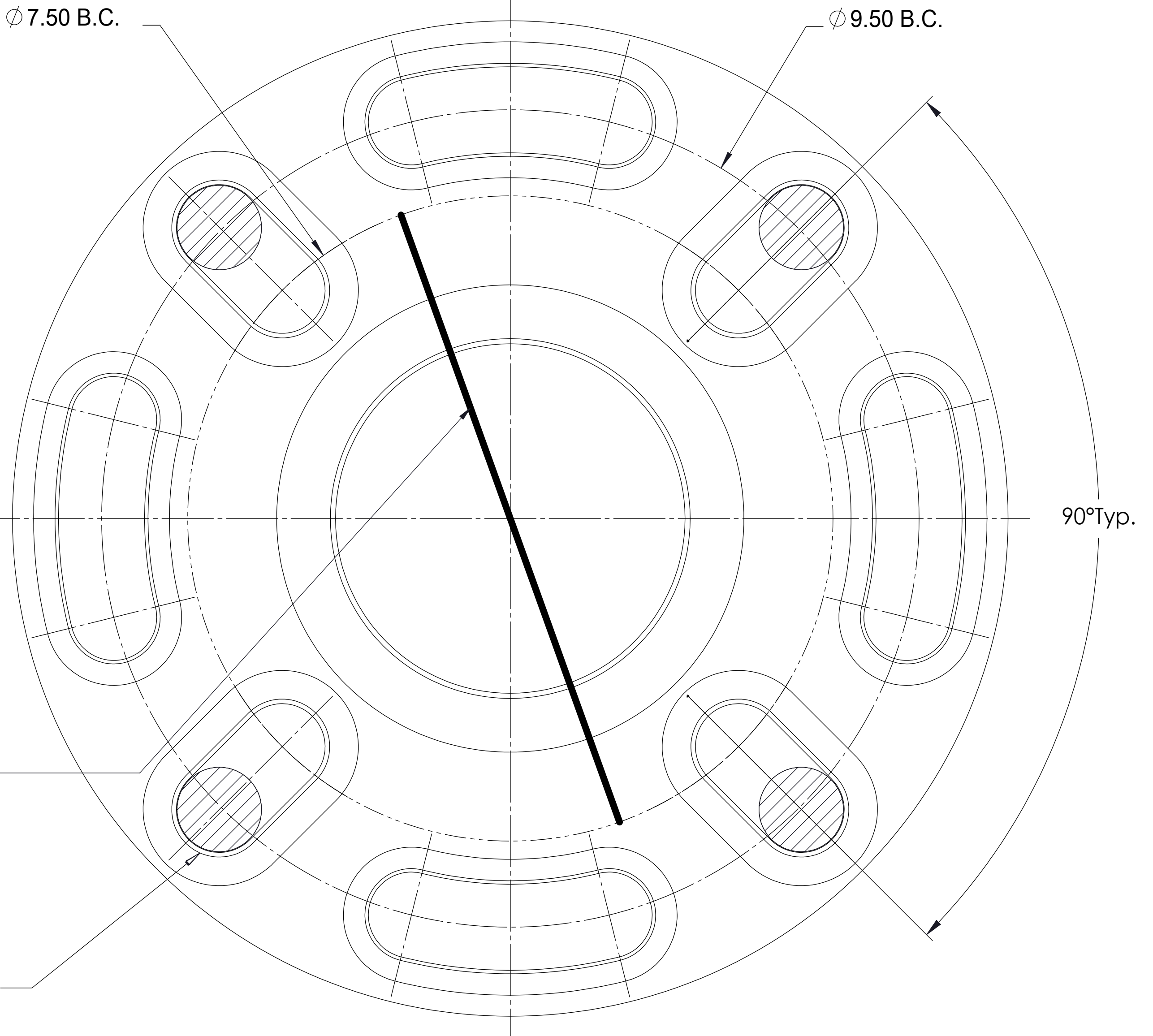

HAND HOLE THIS SIDE HOUSE SIDE

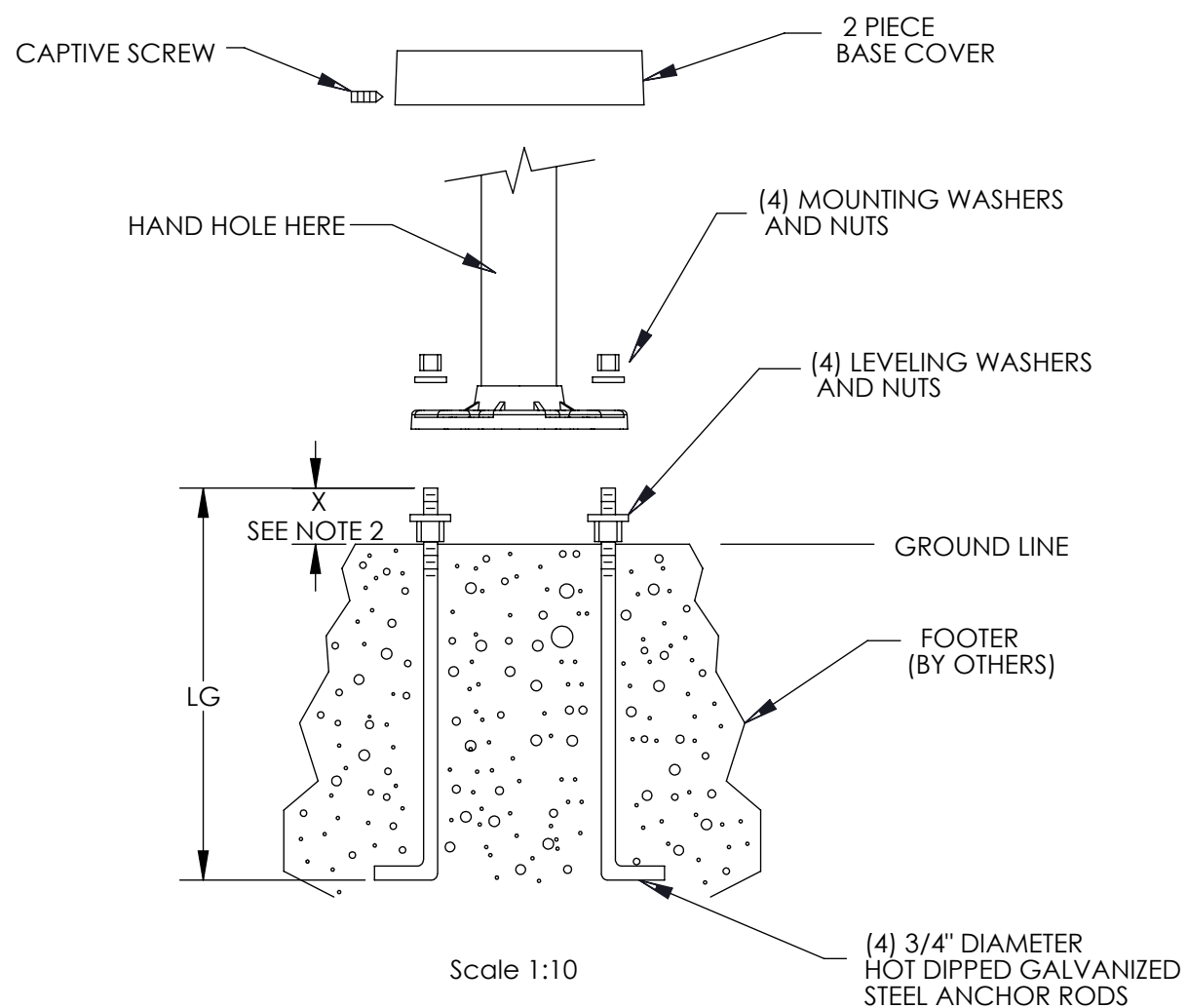

WARNING
**NOT TO SCALE
CONSULT FACTORY FOR
FULL SIZE TEMPLATE.**

NOTES:

- SUGGESTED BOLT CIRCLE: 9 1/2" DIAMETER
MAXIMUM BOLT CIRCLE: 9 1/2" DIAMETER
MINIMUM BOLT CIRCLE: 7 1/2" DIAMETER
- HADCO STRONGLY RECOMMENDS USING LEVELING NUTS TO MOUNT THE POST BASE. IF FOUNDATION IS NOT LEVEL, INCREASE "X" DIMENSION ACCORDINGLY WHEN USING LEVELING NUTS WITH WASHERS.

X = 3" MINIMUM WITH LEVELING NUTS
X = 2" MINIMUM WITHOUT LEVELING NUTS
- IF USING GROUTING TO CONCEAL GAP BETWEEN BASE AND FOUNDATION, ALLOW FOR WATER DRAINAGE.
- ANCHOR ROD: MINIMUM: 3/4" DIAMETER
MAXIMUM: 1" DIAMETER

LG = 20" WHEN USING A 3/4" ANCHOR ROD
LG = 36" WHEN USING A 1" ANCHOR ROD

<p>PHILIPS 100 Craftway, P.O. Box 128 Littlestown, Pennsylvania 17340-0128</p> <p>UNLESS OTHERWISE SPECIFIED: *ALL DIMENSIONS ARE IN INCHES. *ALL THREADS ARE UNC-2B OR UNF-2B AFTER COATING. *ALL THREADS ARE TO BE VERIFIED WITH A THREAD GAGE.</p>	<p>CONFIDENTIAL: This drawing is confidential and proprietary to Philips and may not be reproduced in whole or in part without the express written consent of Philips. All rights reserved. © 2011 by Philips Electronics.</p>		<p>TITLE: TEMP.AR,190</p>	
	<p>DRAWN BY: M. N. BANKERT</p> <p>CHECKED BY: B. DORON</p> <p>APPR BY: E. HADDAD</p>	<p>DATE: 3/5/97</p> <p>DATE: 8/4/09</p> <p>DATE: 3/6/97</p>	<p>DRW SIZE: C</p>	<p>MATERIAL: 17 X 22 WHITE BOND PAPER,</p>
<p>* DO NOT SCALE THIS DRAWING *</p>		<p>EF-04-01-11 Rev.09</p>	<p>SCALE 1:1</p>	<p>SHEET 1 OF 1</p>
<p>PART NO: T01700451</p>				